

QUICK REFERENCE GUIDE

Device Info

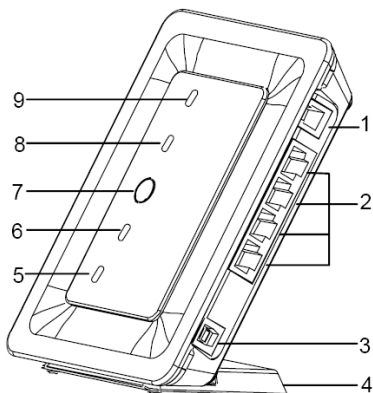

1. Telephone socket
2. Network socket for Ethernet Cable (LAN Cable)
3. Charger/USB Cable socket
4. Pedestal
5. Network mode indicator
6. Signal strength indicator/pin validation
7. ON/OFF key
8. Wireless LAN (Wi-Fi) indicator
9. Power indicator

Connections

Telephone Socket: Connect a standard ICASA approved analogue telephone to make voice calls. Telephones are available from Telkom.

Network socket for Ethernet Cable: Use a network cable to connect to the computer.

Charger/USB socket: **1) Gateway mode** When connecting the USB charger to this socket, the E960 functions as a "Gateway" to allow for Data services (via a LAN Network Cable connections, or Wireless LAN (Wi-Fi)) and voice calls using an analogue telephone. **2) Modem mode** :Use the USB cable to connect a computer to the E960 via the Computer USB socket. In this modem data services only are available via the USB cable.

Step 1: Insert the SIM Card

Caution:

When inserting the SIM card, you must disconnect the E960 from the power adapter or USB connection.

1. Take out the SIM card socket from the E960.
2. Insert the sim card into the socket and then into the E960 with the golden metal contacts facing up,

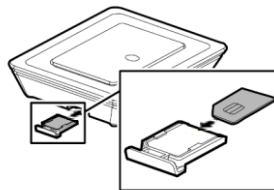

Step 2: Connect the Power

Use the power adapter supplied and connect it to the wall socket.

Step 3: Connect a telephone

Connect a standard ICASA approved telephone to the Telephone socket and place about one meter away from the E960 to minimise interference.

The Signal strength indicator light will flash red.

Enter the SIM card Pin as follows:

Lift the handset

Press the following digits on the keypad:

#*31* xxxx * (where xxxx is the PIN)

- If you hear a **beep** sound **once**, it indicates that the PIN entered is **correct** and the flashing red light will go off.
- If you hear a **beep** sound **twice**, it indicates that the PIN entered is **incorrect**. Then you need to re-enter the PIN code.

Signal strength indicators:

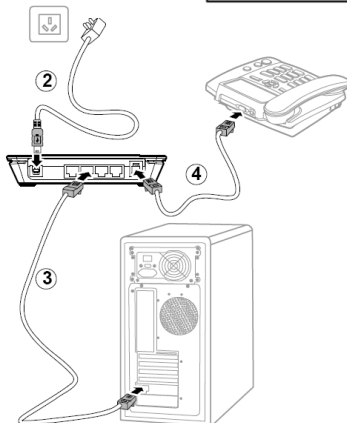

Red blinking – no sim card, or incorrect PIN
Continuous red = Low
Yellow = average
Green = good

Step 4: Connect to a PC

Using Ethernet Network cable (Gateway mode):

Connect a network cable (Ethernet) between any of the network sockets on the E960 and your Computer's network card. If the Network Mode indicator is on, the connection was successful. You may also see a network connection notification on your computer desktop.

The cable should not be longer than 100 meters.

Telkom Data service settings

The E960 should be preconfigured to automatically connect when used in Gateway mode. Should this not be the case the following profile settings must be entered on the web browser GUI: Enter the address <http://192.168.1.1> in web browser to access the GUI

Password = admin

(On the GUI select, advance settings, dial up settings, profile settings)

Enter the following and save

Dial up number : *99#

PPP username : leave blank

PPP password: leave blank

APN : internet

IP Address: select "dynamic"

(On the GUI select, advance settings, dial up settings, PPP settings)

Authentication: select "CHAP"

Click on **Basic Status** to verify whether the PPP has connected.

Using a USB Cable (modem mode)

Using the supplied USB cable, connect the device to your computer's USB connector. Your computer should automatically recognise the device and install the required drivers for your computer. When asked to install "Mobile Partner", continue to install the software. When the **Mobile Partner** software is installed, launch the

program from your desktop by clicking the Mobile Partner icon. Click on the  button and the E960 will connect you to the internet.

CALL FEATURES

The following voice features are available from the ICASA approved analogue telephone connected to the device E960.

Call Waiting

Call Waiting lets you know if someone is calling while you're already on the phone. You can put your first call on hold, take the second call, and switch back again. By default, the call waiting function is inactive.

Call Forwarding

Call Forwarding allow the user to have his incoming calls addressed/re-routed to another number.

Calling Line Identification Restriction (CLIR)

The CLIR service enables the calling party to prevent presentation of it's number to the called party.

Calling Line Identification

Connect any ICASA approved telephone that supports Analogue CLI to the voice port. The number of the person calling will be displayed. The numbers displayed will be in this format:

0027123456789. From the telephone connected to the E960, you can reach this number by dialing the number **0027**123456789 or **0**123456789.

PIN Validation

Normally, you have to enter the PIN to activate the device for data and voice services. When the device is switched on, you can either enter the correct PIN via a telephone connected to the device, or via the device management page (see the comprehensive user manual). If you entered the wrong PIN for three successive times, the PIN is

locked and you need to enter correct PUK to unlock the PIN via the device management page.

Note:

- If the signal strength indicator is fast blinking in red, you need enter the PIN.
- If the signal strength indicator is slowly blinking in red, you need enter the PUK.

Call Feature Codes

Note: The R button on the telephone may be labeled R, Recall or FLASH depending on your handset.

Call Features	Operation using telephone
Activate or de-activate Call Hold (single party)	Press R key will put the call on hold. Pressing it again will de-activate the Call Hold.
Activate Call Waiting	Dial *43#. This will allow you to receive a second call while busy with on a call. The calling party will hear ring tone.
De-Activate Call Waiting	Dial #43#. The calling party will then receive a number busy indication.
Reject a Call Waiting	If you receive an incoming call (waiting call) while busy on a call, and do not want to answer the waiting call, press R0.
End Active Call	If you are busy on a call and receive a second incoming call,(waiting call), you can discontinue the call by pressing R1 and answer the second incoming waiting call
Accept a Call Waiting	When you receive a second incoming call waiting while busy and do not want to end the active call, press R2. This will put the active call on hold and answer the second incoming waiting call.
Alternate between held and active call	When you want to alternate between two calls without ending any call, press R2.
Activate Call Forwarding Unconditional	Dial *21* followed by a destination phone number, then #
Activate Call Forwarding on Busy (Call Waiting must be deactivated)	Dial *67* followed by a destination phone number, then #
Activate Call Forwarding on No Reply	Dial *61* followed by a destination phone number, then #
De-Activate all Call Forwarding	Dial #22#
Activate CLIR	Dial #31# - this will prevent your number being displayed to the destination party.
De-activate CLIR	Dial *31#
Validate PIN	Dial ##31* xxxx * (where xxxx is the PIN)

Note:

- If the SIM card was set for PIN request, when powered on, the red signal light shines quickly(100ms light, 100ms off) to remind the user to input the PIN
- The PIN contains 4~8 digits. If the entered PIN is less than 4 digits, the machine will play the failure beep sound but the remaining times are not reduced.
- If you hear a beep sound once, it indicates that the PIN entered is correct..
- If you hear a beep sound twice, it indicates that the PIN entered is not correct. Then you need to reset the PIN code.
- If you enter the incorrect PI for more than 3 times, the red signal light shines slowly(1 s light, 1 s off) to remind the user PUK is activated, you can only use Mobile Partner or WEB GUI to unlock;(see the full user manual)
- If you enter the correct PIN, the E960 begins to search the network. When network is available, then the signal strength indicator will shine red, yellow or green.
- When the telephone handset is picked up, a continuous tone will indicate that a phone call can be made. If the tone is interrupted, then either the PIN is incorrect. (signal strength indicator = blinking red) or there is no enough signal.

Note:

- Do not connect more than two analogue telephone handsets to the analogue port (telephone line socket) of the device at the same time.
- The maximum distance of the telephone line connected to the analogue port (telephone line socket) of the device is 1500m.
- Traditional paper fax machines cannot be connected to the analogue port (telephone line socket) of the device.
- An analogue modem does not work with the E960.
- For additional help:
Visit: www.dotelkomphones.co.za
Helpdesk: 0861 627 334